

1. Handling

Unit Volume / Weight

Unit Ref	Volume (m³)	Weight (kg)
LG14	0.878	2,065

Weight is based on 2,350 kg/m³

Lifting system is by means of a 180mm long spherical pin anchor rated at 5.0 tonnes with a safety factor of 3.

Lifting is achieved by use of a 5.0t rated pin anchor ring clutch or combination ring clutch only and should comply with the Lifting Operation & Lifting Equipment Regulations 1998 (LOLER).

2. Concrete

Characteristic 28 day cube strength = 50 N/mm² min.
Concrete is Class A1 Fire Resistant in accordance with clause 4.3.4.4 of EN 13369

3. Manufacture

Manufactured to : BS EN 13369 : 2013
Tolerances to : BS EN 13670 : 2009

4. Physical & Chemical Properties

Appearance : Grey in Colour
Other Chemical Properties : Not Applicable

5. Design

Design Life : >100 years

6. Manufacture Tolerances

Length	±5mm
Width	±5mm
Height	±5mm

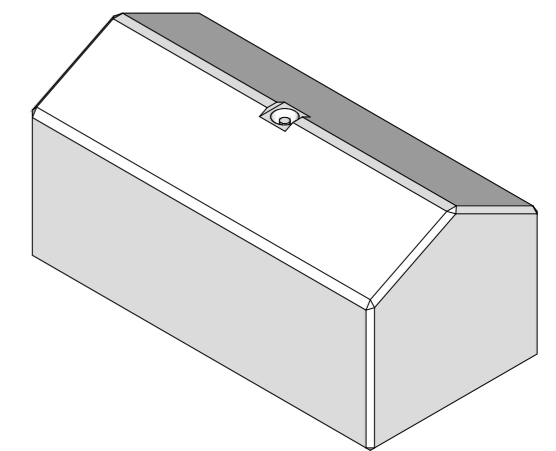

REV	DATE	REASON FOR ISSUE	DRN	APP	REV	DATE	REASON FOR ISSUE	DRN	APP	CTC	RMD	DRN	CTC	CHKD	RMD	DATE	SIZE	SCALE	DRG	REV
					O	04.05.21	For Information.									04-05-21	A3	1:15	EPC-LEG-015	O

TITLE
Legato® Interlocking Concrete Block
1600mm x 789mm (800) x 800mm Capping Block
 Elite Product Code : LG14

ELITE PRECAST CONCRETE LTD
 HALESFIELD 9, TELFORD
 SHROPSHIRE TF7 4QW

ELITE PRECAST CONCRETE