

1. Handling

Unit Volume / Weight

Unit Ref : **LG10**
 Volume : **0.755 m³**
 Weight : **1800 kg**

- Weight is based on 2,350 kg/m³
- Lifting system is by means of a 180mm long spherical pin anchor rated at 5.0 tonnes with a safety factor of 3.
- Lifting is achieved by use of a 5.0t rated pin anchor ring clutch or combination ring clutch only and should comply with the Lifting Operation & Lifting Equipment Regulations 1998 (LOLER).

Lifting Pin Characteristics

Anchor Type : **T-050-0180**
 Anchor Length : **180mm**
 dia : **20mm**
 Foot dia : **50mm**
 Load Class : **5.0 tonnes**

IMPORTANT NOTE :

Prior to lifting older / pre-used blocks, check the lifting pin for wear / corrosion and check the block for cracks. If the block is cracked or the pin is worn, it could fail when lifting.

2. Concrete

- Characteristic 28 day cube strength = 50 N/mm² min.
- Concrete is Class A1 Fire Resistant in accordance with clause 4.3.4.4 of EN 13369

3. Manufacture

- Manufactured to : **BS EN 13369 : 2013**
- Tolerances to : **BS EN 13670 : 2009**

4. Physical & Chemical Properties

- Appearance : Grey in Colour
- Other Chemical Properties : Not Applicable

5. Design

- Design Life : **>100 years**

6. Manufacture Tolerances

- Length **±5mm**
- Width **±5mm**
- Height **±5mm**

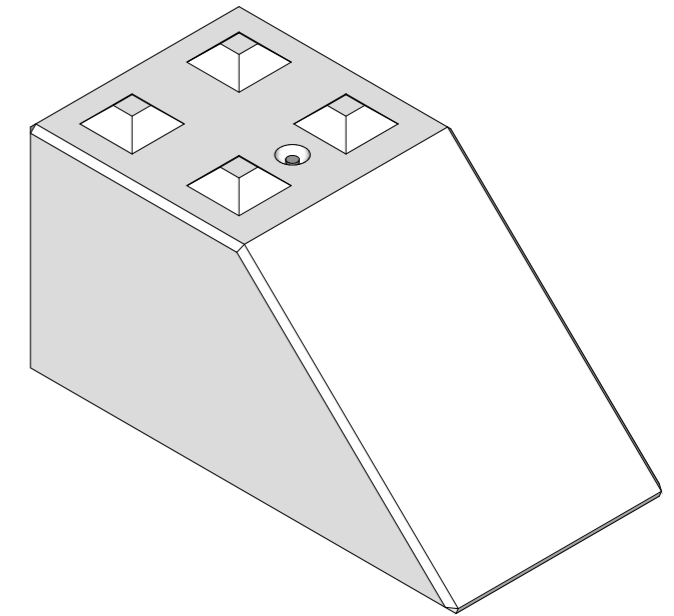
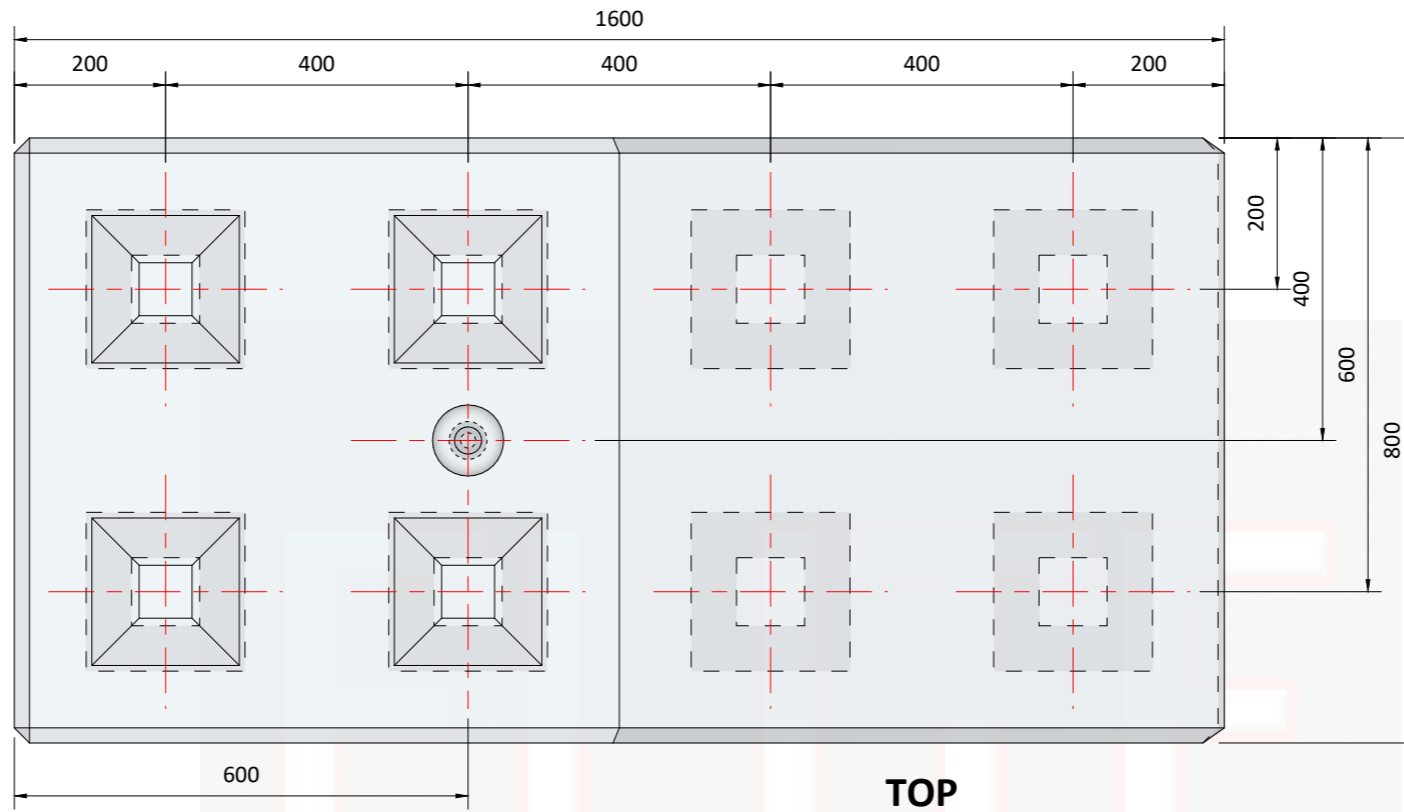

Isometric View

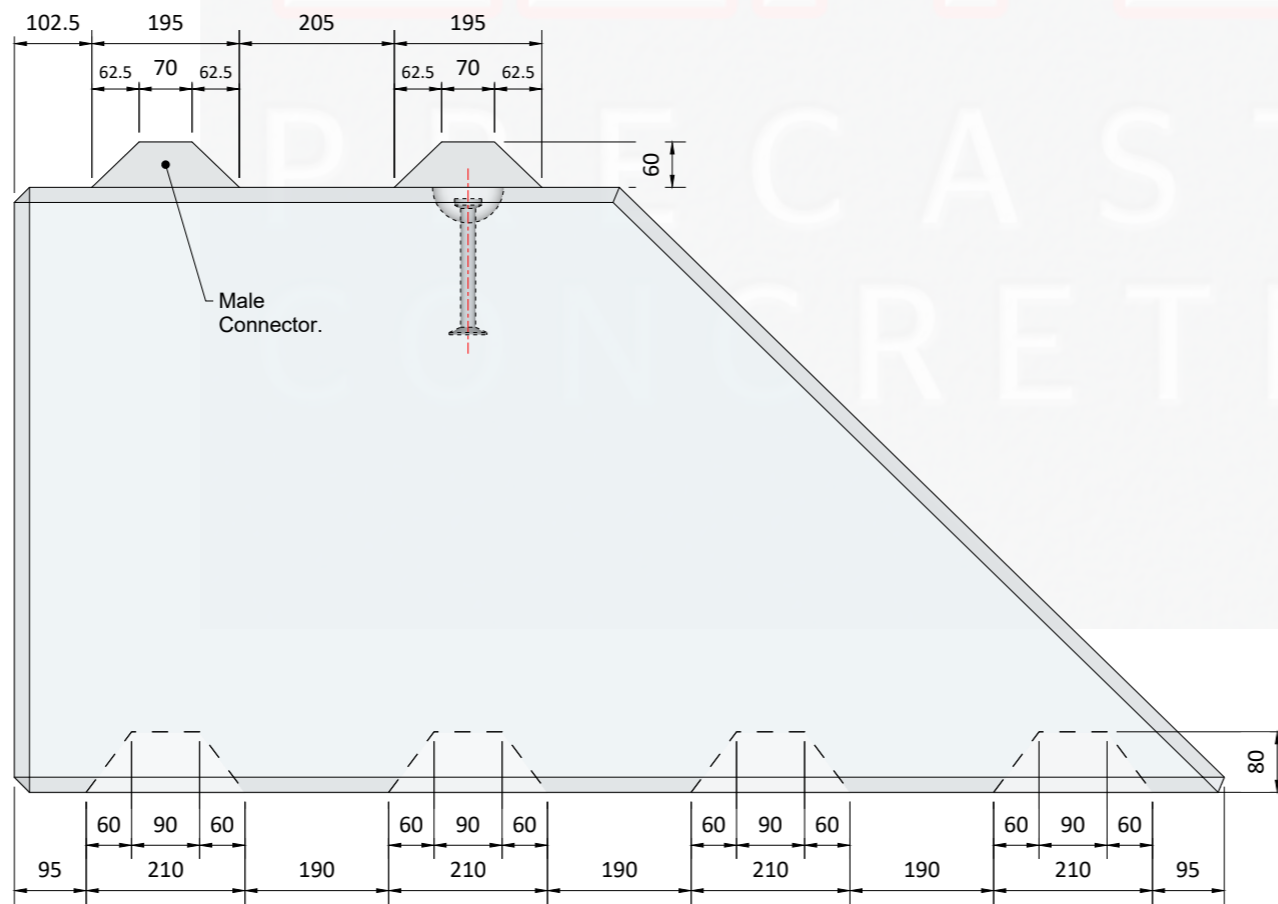

FRONT

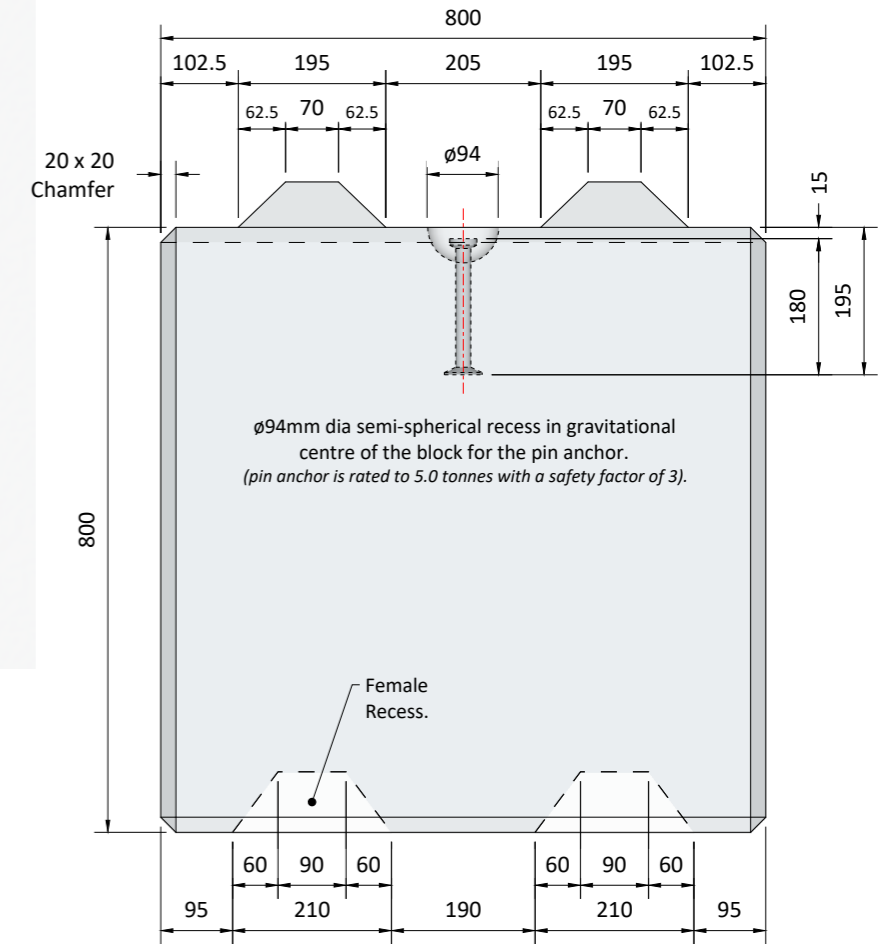

SIDE

REV	DATE	REASON FOR ISSUE	DRN	APP	REV	DATE	REASON FOR ISSUE	DRN	APP	TITLE	DATE	SIZE	SCALE	DRG	REV	
					C	20.01.22	Drawing & title block updated.	CTC	RMD	Legato® Interlocking Concrete Block 1600mm x 800mm x 800mm (Male / Female Interlocks) Elite Product Code : LG10	23-06-16	A3	1:10	EPC-LEG-010	D	
				B	12.03.20	Registered Trademark ® added to the drawing.	CTC	RMD								
				A	03.01.18	Drawing revised & updated.	CTC	RMD								
				O	23.06.16	For Information.	CTC	RMD								
D	20.01.23	Title block & notes updated.	CTC	RMD	O	23.06.16	For Information.	CTC	RMD							

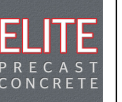

ELITE PRECAST CONCRETE LTD
 HALESFIELD 9, TELFORD
 SHROPSHIRE TF7 4QW
 www.eliteprecast.co.uk